

CRL ALUMINUM DOOR MOUNTED STANDARD PULL HANDLES

CRL MITERED CORNER GLASS MOUNTED PULL HANDLE

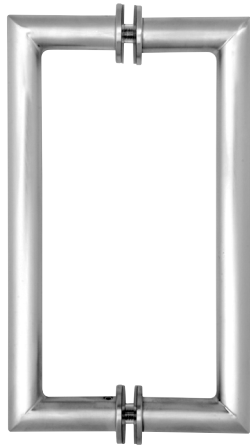

CAT. NO.
 MH10X10
 MH12X12
 MH18X18
 MH24X24

INCLUDED MOUNTING HARDWARE

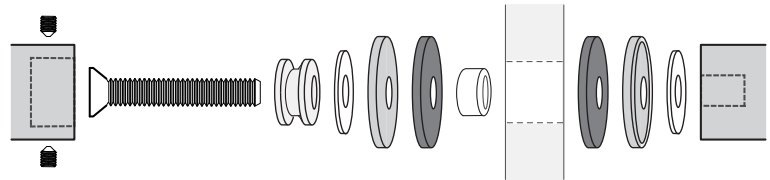

5/16"-18 Back-to-Back
 Glass Door Mount Shown

MOUNTING TEMPLATE

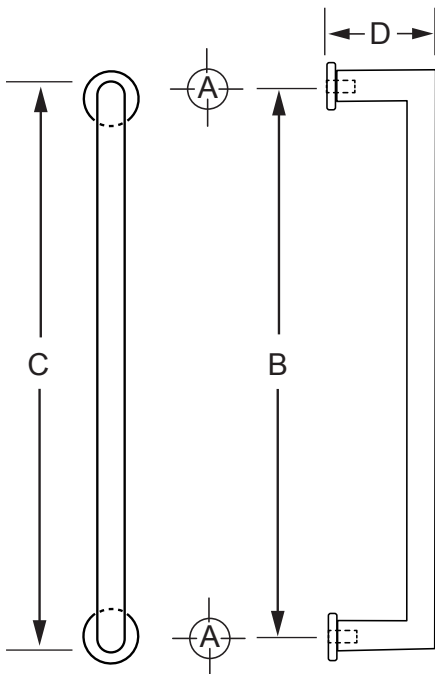

ADD TO CAT. NO. FOR FINISH

BS = BRUSHED STAINLESS

PS = POLISHED STAINLESS

CAT. NO.	Hole Size: A		B	C	D
	Glass	Wood/ Aluminum			
MH10X10	5/8" (16 mm)	5/16" (8 mm)	10" (254 mm)	11" (279 mm)	3" (76 mm)
MH12X12	5/8" (16 mm)	5/16" (8 mm)	12 (305 mm)	13" (330 mm)	3" (76 mm)
MH18X18	5/8" (16 mm)	5/16" (8 mm)	18" (457 mm)	19" (483 mm)	3" (76 mm)
MH24X24	5/8" (16 mm)	5/16" (8 mm)	24" (610 mm)	25" (635 mm)	3" (76 mm)

Mounting Options	Glass 3/8"-3/4" (10 to 19 mm)	Wood/Aluminum up to 1-3/4" (45 mm)
Mounting Hardware	F40WK Included	Cat. No. TB4CH

NOTE: Optional hardware kits must be purchased separately.

